

Drawings for the complete stage replacement for the PAC, June-August, 2012

Notes:

- 1) Stage has to be some 8" lower than the previous one to allow 8' flats to fit under the new reinforcing trusses under the roof beams.
- 2) New stage will be supported by composite I-joists. (Expanded x8 end view drawing at right.)
- 3) The old stage was *not perpendicular to the walls*. (Difference from perpendicular is 0.6° .) On the East wall, the supports were 5" closer to the edge of the stage (38" and 218" instead of 43" and 223"). The new stage will be rectangular and symmetric.
- 4) Stage will be two layers: Tongue-and-groove oriented strand board (T&G OSB) in 4' x 8' sheets will be stapled and glued to the I-joists and glued to each other. Top layer will be 4' x 8' sheets of Plyon. Whole thing framed by 2x6s on front and back (north and south) sides. Left and right sides come to within $\sim 1/4$ " of the walls; gap is trimmed with $3/4$ " quarter-round. Cross-section drawing is below.
- 5) The file `PACStageRedesign-2012-All.CAD` has all this plus lots of detritus from the drawing creation process.

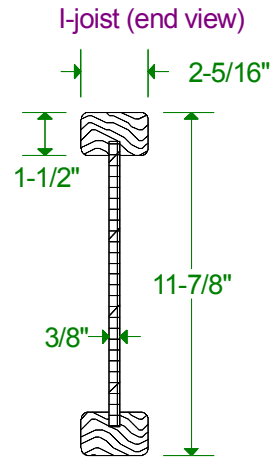
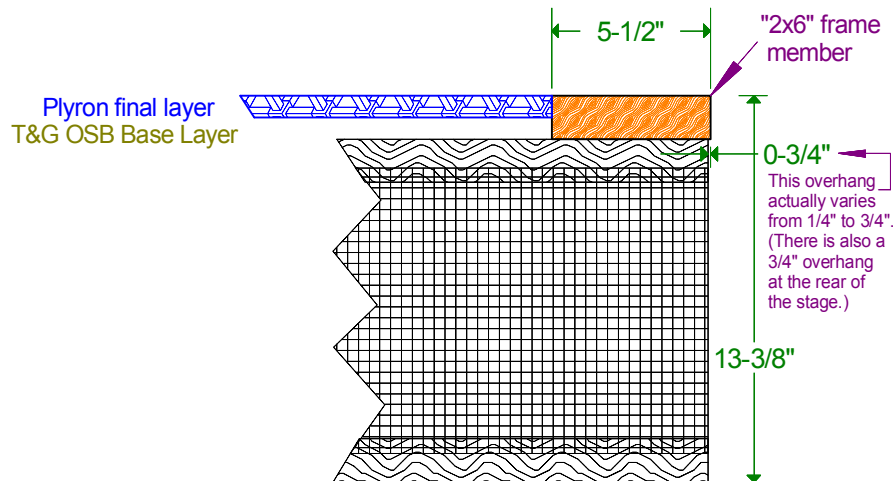

LALT Stage Reconstruction

August, 2012

